



Notice of utility survey works at M6 J15, Hanchurch Interchange and A500 (subject to consent)

February 2023 | www.hs2.org.uk

High Speed Two (HS2) is the new high speed railway for Britain. Working on behalf of HS2 Ltd, Balfour Beatty is carrying out surveys along the Phase 2a route.

What we are doing

HS2 Ltd is proposing to make changes to the M6 Hanchurch Interchange at Junction 15, Newcastle Road, Clayton Road and the junction of Newcastle, Trentham and Whitmore Road, to improve the traffic flows during the construction of HS2.

During the detailed design stage of the process, we have highlighted four areas where further utility surveys are required.

Due to the location of these surveys and to enable us to complete them safely we will need to install traffic management during the work. We have worked hard to reduce the impact however, there will be three-night shifts required to complete the work.

Resident access will also remain uninterrupted throughout.

When the work will take place

The daytime surveys will be completed between

Wednesday 8 March to Tuesday 14 March 2023

8am until 5pm (Subject to Consent)

The night time surveys will be completed between

Wednesday 15 March to Friday 17 March 2023

8pm until 5.30am (Subject to Consent)

**If you have a question about HS2 or our works, please
contact our HS2 Helpdesk team on 08081 434 434
or email hs2enquiries@hs2.org.uk**

Duration of works

Wednesday 8 March until
Tuesday 14 March 2023
8am to 5pm,

Wednesday 15 March
until Friday 17 March

8pm and 5:30am.

What to expect

Day time:

Road narrowing with
cones and signs on
Clayton Road and
Newcastle Road.

Night time:

Five-way temporary traffic
lights at Newcastle Road/
Whitmore Road junction
overnight

Lane closure on A500
northbound and
southbound carriageways

Some noise from
equipment used for the
works.

We will be onsite one hour
either side of the advised
times to set-up and close-
down the worksite.

Please plan ahead and
allow additional time for
your journey.

What we will do

We will inform people of
any changes in advance.

Notice of utility survey works at M6 J15, Hanchurch Interchange and A500 (subject to consent)

Notification



www.hs2.org.uk

When will the works take place

2 Day shifts

Wednesday 8 March until Thursday 9 March 2023

9:30am until 3:30pm

Location 1

Road narrowing on Newcastle Road southbound, between No. 25 and No. 31.

Access to these properties will be maintained.

5 Day shifts

Wednesday 8 March until Tuesday 14 March 2023

8am until 5pm

Location 2

Road narrowing on Newcastle/Clayton Road southbound on approach to Hanchurch Roundabout.

1 Night shift

Wednesday 15 March 2023

8pm until 5.30am

Location 3

Five-way temporary traffic lights at Newcastle Road/ Whitmore Road junction.

2 Night shifts

Thursday 16 March until Friday 17 March 2023

8pm until 5.30am

Location 4

M6 J15 southbound exit slip reduced to one lane, outer lane of Hanchurch Roundabout closed, A500 northbound lane 1 closed and A500 southbound lane 1 closed.

Notice of utility survey works at M6 J15, Hanchurch Interchange and A500 (subject to consent)

Notification



www.hs2.org.uk

How this may affect you

In all cases our works will be performed with hand tools with the exception of the works between Thursday 16 March until Friday 17 March 2023 on the A500 northbound. Due to the extent of these works, the excavation will utilise a vacuum excavator. We will aim to utilise this at the start of the shift to reduce the impact of the works. Some noise should be expected during these shifts.

Please plan and allow extra time for your journeys during these times.

Location 1 Newcastle Road southbound Wednesday 8 March to Thursday 9 March 2023, 9:30am until 3:30pm



Contact our HS2 Helpdesk team on **08081 434 434**

Notice of utility survey works at M6 J15, Hanchurch Interchange and A500 (subject to consent)

Notification



www.hs2.org.uk

Location 2 Newcastle/Clayton Road southbound on approach to Hanchurch Roundabout Wednesday 8 March until Tuesday 14 March 2023, 8am until 5pm

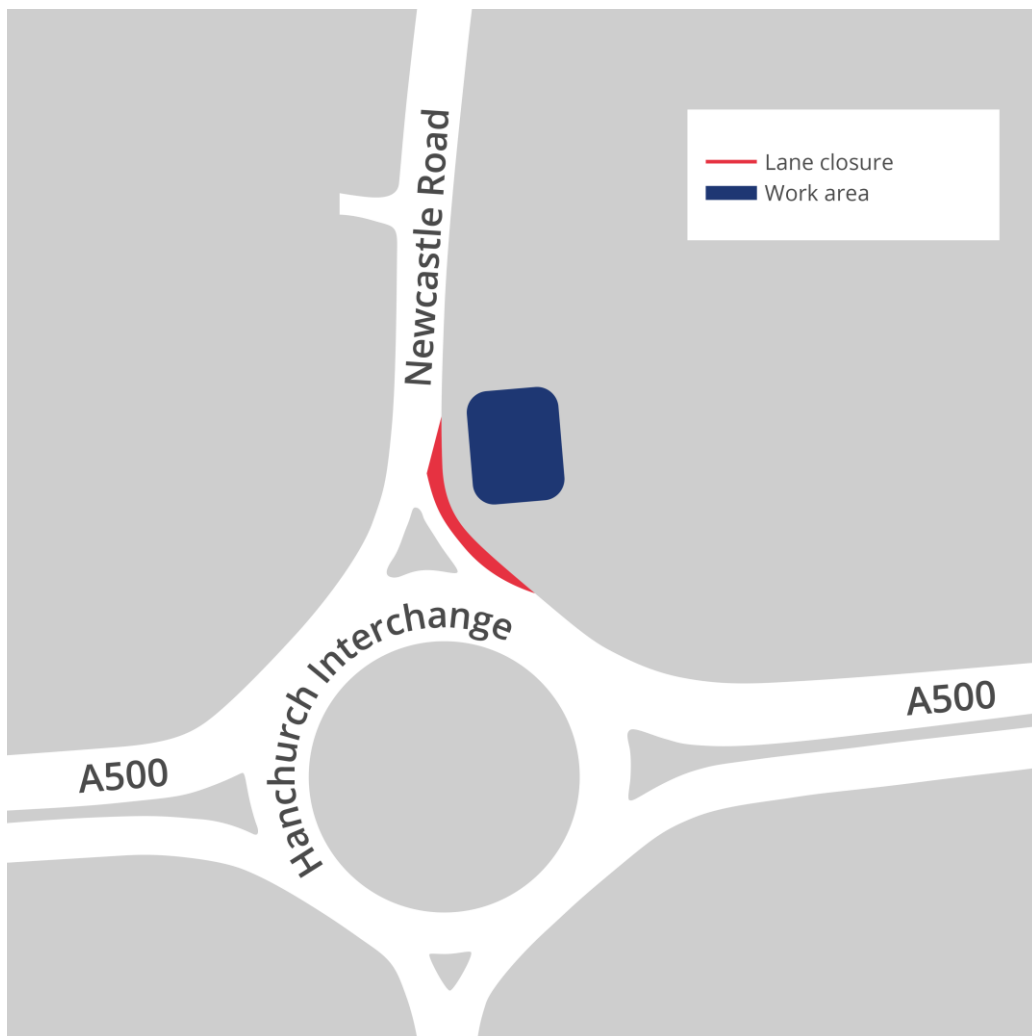

Contact our HS2 Helpdesk team on **08081 434 434**

Notice of utility survey works at M6 J15, Hanchurch Interchange and A500 (subject to consent)

Notification



www.hs2.org.uk

Location 3 Five-way lights at Newcastle Road/ Whitmore Road junction, Wednesday 15 March 2023, 8pm until 5.30am

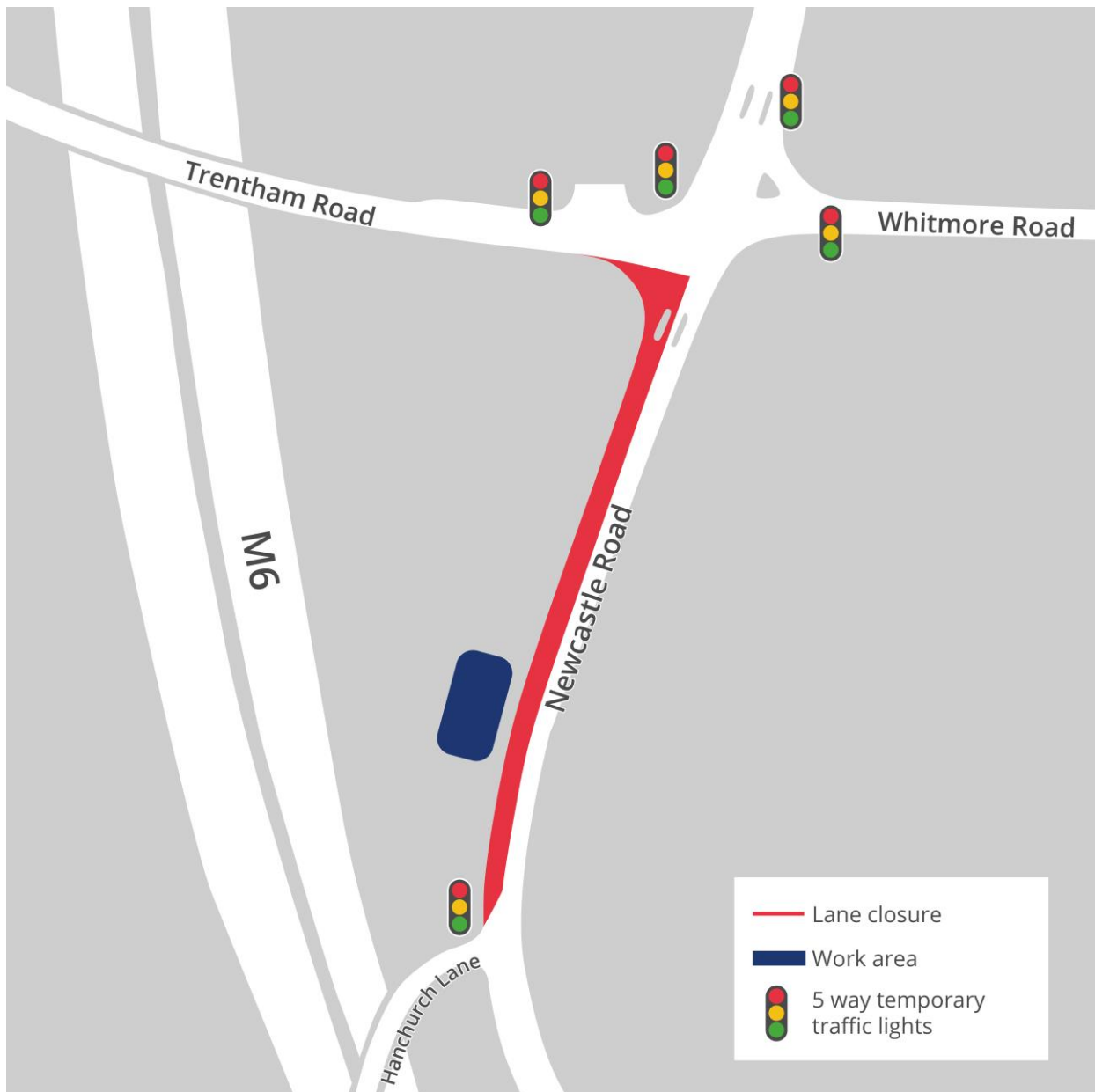

Contact our HS2 Helpdesk team on **08081 434 434**

Notice of utility survey works at M6 J15, Hanchurch Interchange and A500 (subject to consent)

Notification



www.hs2.org.uk

Location 4

M6 J15 southbound exit slip reduced to one lane, outer lane of Hanchurch Roundabout closed, A500 northbound lane 1 closed and A500 southbound lane 1 closed, Thursday 16 March until Friday 17 March 2023 8pm until 5.30am

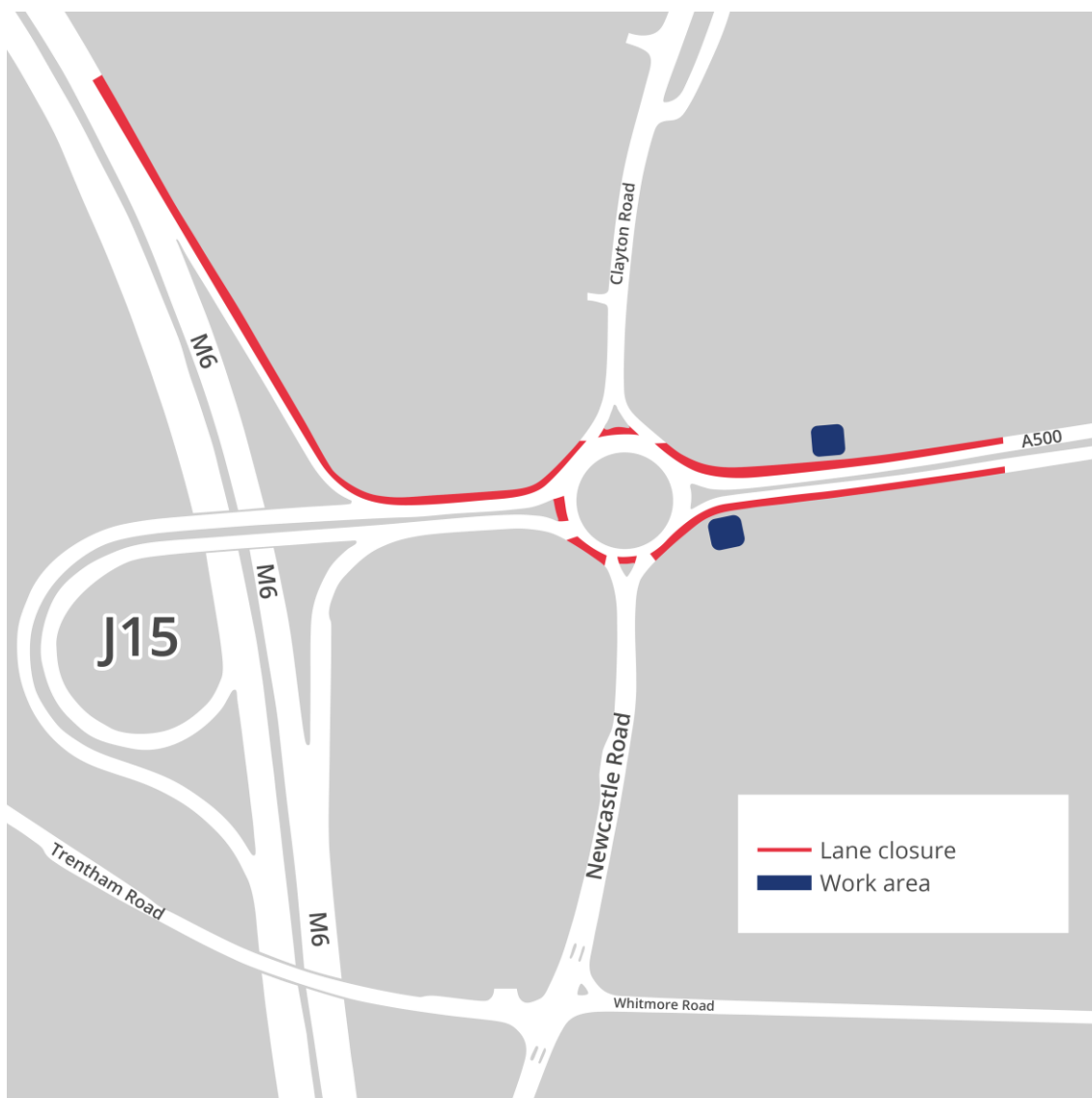

Contact our HS2 Helpdesk team on **08081 434 434**

Keeping you informed

We are committed to keeping you informed about work on HS2. This includes ensuring you know what to expect and when to expect it, as well as how we can help you.

The Residents' Commissioner

The independent Residents' Commissioner oversees and monitors our commitments to you.

The commissioner's reports and our responses can be found at www.gov.uk/government/collections/hs2-ltd-residents-commissioner

The Residents' Commissioner makes sure we fulfil the commitments in the HS2 Community Engagement Strategy (<https://bit.ly/3oOA25j>).

The Residents' Commissioner can be contacted on: residentscommissioner@hs2.org.uk

Construction Commissioner

The independent Construction Commissioner regularly meets our Chief Executive Officer to raise any concerns or emerging trends across HS2.

The Construction Commissioner's role has been developed to monitor the way we manage and respond to construction complaints.

The commissioner mediates on disputes about construction, involving individuals and organisations, that we can't resolve. The commissioner advises members of the public about how to make a complaint about construction.

The Construction Commissioner can be contacted on: complaints@hs2-cc.org.uk

Property and compensation

You can find out about HS2 and properties along the route by visiting:

www.gov.uk/government/collections/hs2-property

Find out if you can claim compensation at:

www.gov.uk/claim-compensation-if-affected-by-hs2

Holding us to account

If you are unhappy for any reason you can make a complaint by contacting the HS2 Helpdesk. For more details on our complaints process, please visit:

www.hs2.org.uk/in-your-area/contact-us/how-to-complain/

Reference number: HS2-EW-BB-Ph2a-Ar-CA01-Surv-19-09/02/2023

High Speed Two (HS2) Limited, registered in England and Wales.

Registered office: Two Snowhill, Snow Hill Queensway, Birmingham B4 6GA.

Company registration number: 06791686. VAT registration number: 888 8512 56

Contact us

Contact our HS2 Helpdesk team all day, every day of the year on:

 Freephone **08081 434 434**

 Minicom **08081 456 472**

 Email **HS2enquiries@hs2.org.uk**

Write to:

FREEPOST

HS2 Community Engagement

Website **www.hs2.org.uk**

To keep up to date with what is happening in your local area, visit:
www.HS2inyourarea.co.uk

Please contact us if you'd like a free copy of this document in large print, Braille, audio or 'easy read' format. You can also contact us for help and information in a different language.

HS2 Ltd is committed to protecting personal information. If you wish to know more about how we use your personal information please see our Privacy Notice:

<https://www.gov.uk/government/publications/high-speed-two-ltd-privacy-notice>